

Toledo Elementary School

**Kindergarten Hybrid
Begins October 12, 2020**



Welcome



Disclaimer: Professional driver on closed course. Do not attempt. Always secure your pets.



Agenda

1

Useful Information

Look at changes from CDL-Hybrid

2

Safety Protocols

What will your child's day look like at school?

3

Questions

Please ask any questions that you have.



Moving from CDL-Hybrid

Hybrid
At School
A -Mon/Thurs
B-Tues/Fri

Students will be assigned an A/B cohort. On their designated day, they will come to school to receive in person instruction from a kindergarten teacher.

Hybrid
At Home
B- Mon/Thurs
A- Tues/Fri

Students will be assigned an A/B cohort. On their designated day, they will stay at home to receive CDL instruction from a kindergarten teacher.

CDL
At Home
Mon, Tues, Thurs, Fri

Students in this option will NOT come to school but will continue to receive CDL instruction from a kindergarten teacher at home.



Contact for questions
learning at school.

Meet Our Teachers

Contact for questions
learning at home.

Hybrid At School

Mrs. Eller - A/B cohort at school

Mrs. Rozewski -A/B cohort at school

Hybrid At Home/CDL

Mrs. Moore - A/B cohort at home
- CDL at home



Daily Schedules

Hybrid At School

8:45-9:00 - Breakfast at school
9:00 - Attendance Bell at school
9:00 - Regular School Day begins
3:00 - Dismissal

*Limit late arrivals and early pickups

*Early pickups will not be allowed after 2:30

Hybrid At Home/CDL

8:00-8:45 - Breakfast at home
8:45-9:00 - LIVE Begin the day with teacher online - Morning Meeting

11:10-12:10 Lunch/Recess

2:45-End Online Day

3:00-3:45 - Available for appointments

*CDL schedule may shift when Hybrid begins.



Hybrid To/From School



Proof of Birth Date



Must have in order to be enrolled in public school

*small grace period and we are nearing the end



Can include:

*birth certificate, any legal document with birthdate, tribal card, bassinet card, passport, health document



email: toledoeloffice@lincoln.k12.or.us
or bring to the school



Safety Protocols

Parent Home Screen

— No visitors/volunteers

Teacher screen at door





Isolation room if needed

Breakfast and Lunch in the classroom

Increased hand washing and sanitizing

[LCSD Blueprint for Reopening](#)



SYMPTOMS OF ILLNESS	STUDENT MAY RETURN AFTER... *The list below tells the shortest time to stay home. A student may need to stay home longer for some illnesses.
 Fever: temperature by mouth of 100.4°F or Higher	*Fever-free for 24 hours without taking fever-reducing medicine AND after a COVID-19 test is negative, OR 10 days if not tested.
 New <u>cough</u> illness OR New difficulty breathing	*Symptom-free for 24 hours AND after a COVID-19 test is negative, OR 10 days if not tested. If diagnosed with pertussis (whooping cough), the student must take 5 days of prescribed antibiotics before returning.
 <u>Headache</u> with stiff neck or with fever	*Symptom-free OR with orders from doctor to school nurse. Follow fever instructions if fever is present.
 <u>Diarrhea:</u> 3 loose or watery stools in one day OR newly not able to control bowel movements	*Symptom-free for 48 hours OR with orders from doctor to school nurse.
 <u>Vomiting:</u> one or more episode that is unexplained.	*Symptom-free for 48 hours OR with orders from doctor to school nurse.
<u>Skin rash</u> or open sores	*Symptom-free , which means rash is gone OR sores are dry or can be completely covered by a bandage OR with orders from doctor to school nurse.
<u>Red eyes</u> with eye discharge: yellow or brown drainage from the eyes	*Symptom-free , which means redness and discharge are gone OR with orders from doctor to school nurse.
<u>Jaundice:</u> new yellow color in eyes or skin	*After the school has orders from doctor or local public health authority to school nurse.
<u>Acting different without a reason:</u> unusually sleepy, grumpy, or confused.	*Symptom-free , which means return to normal behavior OR with orders from doctor to school nurse.
<u>Major health event,</u> like an illness lasting 2 or more weeks OR a hospital stay.	*After the school has orders from doctor to school nurse.
Student's health condition requires more care than school staff can safely provide	*After measures are in place for student's safety.



Parent Pick Up/Drop Off



TOLEDO ELEMENTARY
600 SE Sturdevant
Toledo, Oregon

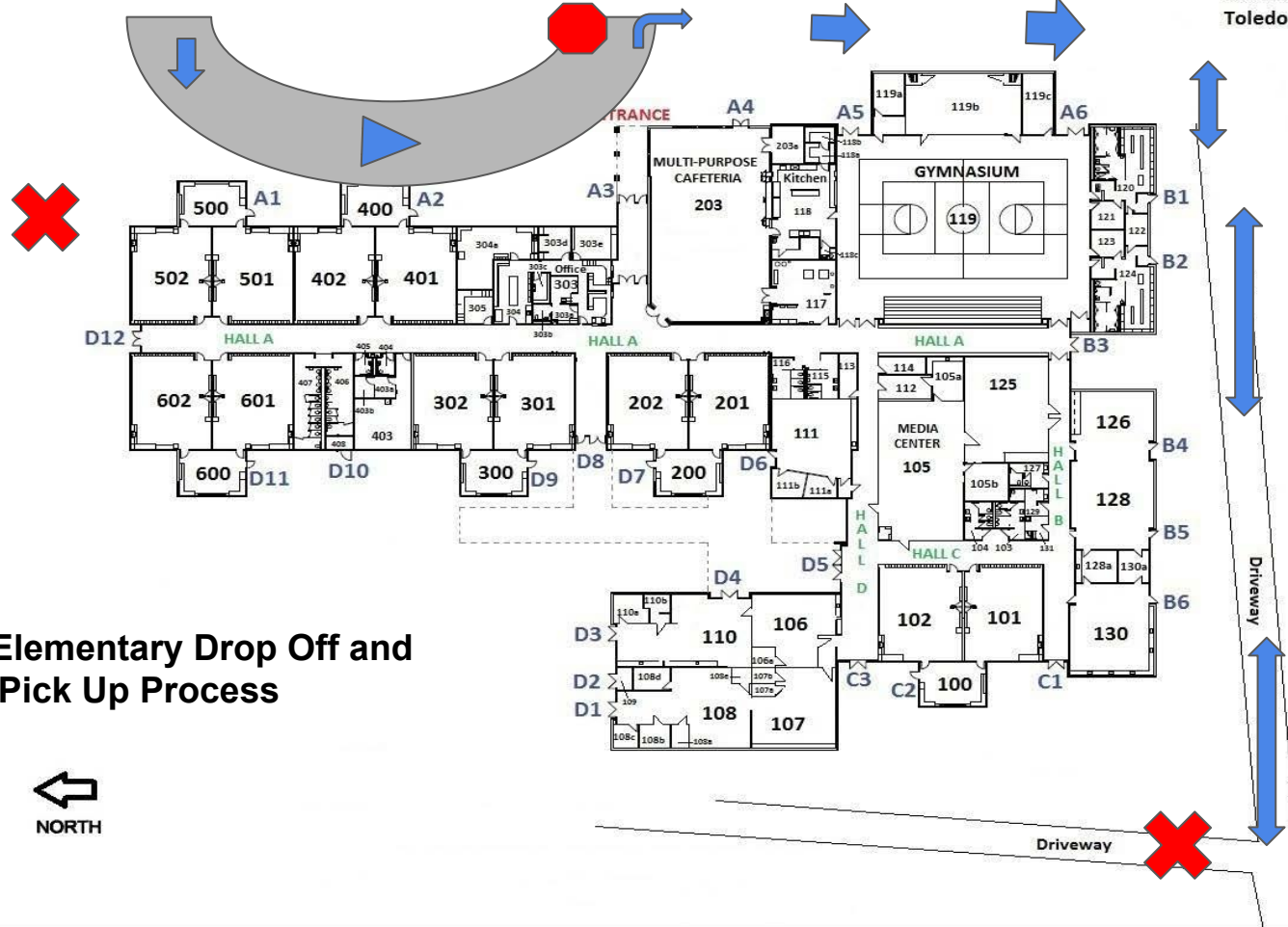

Toledo Elementary Drop Off and Pick Up Process



School Map
1.14.16

Sturdevant Road

Car Tags and Student Labels



Transportation



We are no longer able to make daily bus changes for your child. Bus changes are restricted at this time in an effort to maintain safety and cohorting. In the unlikely event that a permanent change has to be made, allow up to one week to implement the service. Any child who does not follow their planned bus ride will be removed from the route after 2 weeks.

We are able to make a temporary change for a student from buser to car rider. These changes **MUST** be in writing and received no later than **11:00a.m.** daily.

toledoeloffice@lincoln.k12.or.us Follow up with a phone call 541-336-5121.

Kindergarteners will wear a sticker daily that has their bus #, emergency contact info and address. Please remove and throw away as soon as your child gets home. A new one will be issued daily.





We are in this
together 



Questions?

